

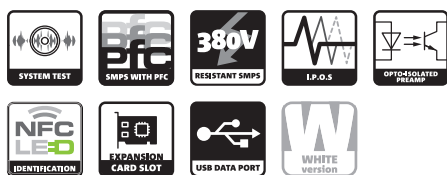

Datasheet

VIO S118

Active Horn-loaded Flyable Subwoofer
1x 18", 1600W RMS



This flyable active subwoofer, equipped with a 18" neodymium transducer, has been crafted to complete the accurate and phase coherent wave front of VIO Line Arrays with impressive low-end frequencies and vigorous SPLs. VIO S118 also features a NFC™ system and a LED on the front grille. S118's cabinet is equipped with integrated hardware allowing 1 or more subs to be flown in a sub array or on the top of a VIO L210 array. Furthermore the subwoofer can be flown with DRK-210 flybar in inverted orientation to create flown cardioid arrays.

Features

- flyable active 1x 18" horn loaded subwoofer
- 1600W RMS amplifier
- SMPS with PFC
- system-test for quick diagnostics
- designed for maximum efficiency in the lower end
- on board delay for perfect time alignment
- on board cardioid array configuration preset
- modular slot for network and digital audio expansion cards (RDNet card installed)

Speaker Type	Active Horn-Loaded Flyable Subwoofer
Usable Bandwidth [-10dB]	33 Hz (HPF)
Frequency Response [-6dB]	36 Hz to cut frequency (X-Over Dependent)
Max SPL	139 dB
LF	1x 18", Neodymium
Voice Coil LF	4"
Directivity	Omnidirectional
Amplifier	1600 W RMS Class-D Digipro® G4
Cooling	Convection, internal fan
Power Supply	Full-range SMPS with PFC (100V~240V~, 50-60Hz)
Controller	DSP 32 Bit
AD/DA Converter	24 bit 96 kHz
Limiters	Peak, RMS, Thermal
Delay Option	0 - 9.9 ms internal steps of 0.1 ms [on-board]
Xover Frequency LF-Xover out	Selectable 60-110 Hz + Full Range (8 steps)
LF-Xover out slope	24 dB/Octave
Signal Input	1 x XLR balanced, 1x USB Data Service
Signal Output	1x XLR balanced (link or X-over)
Power Socket	1x PowerCON TRUE1 In 1x PowerCON TRUE1 Out
Expansion Card	RDNet Card (1x RJ45 IN 1x RJ45 Link) Dante Card [Optional]
Controls	1x Input Attenuation Rotary Switch 1x Rotary Encoder (Delay 9.9 ms) 1x Polarity Inversion Switch (0° or 180°) 1x Cardioid Mode Switch 1x X-Over Freq Rotary Encoder (8 steps) 1x System Auto-test
Special Features	380V Resistant SMPS IPOS Intelligent Power-On Sequence Opto-isolated floating pre-amp System Test (transducers diagnostics) NFC™ and Frontal LED Identification System
Housing	Multiplex plywood - Polyurea painting
Handles	2x per Side, Aluminium
Pole Mount	M20 Thread
Rain cover	Included
Rigging Points	2x Pick Points on top to stack DRK-210 8x Flying Hardware (4x on top, 4x on bottom)
Width x Height x Depth	720 x 520 x 700 mm (28.34 x 20.47 x 27.56 in)
Weight	45.1 kg (99.42 lbs)

VIO S118

Datasheet

OVERALL DIMENSIONS

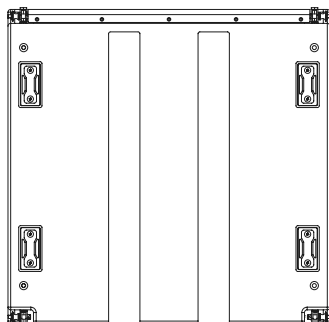
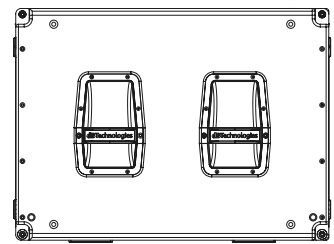
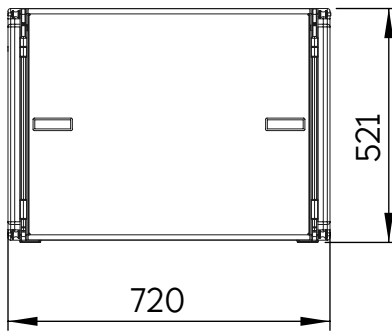
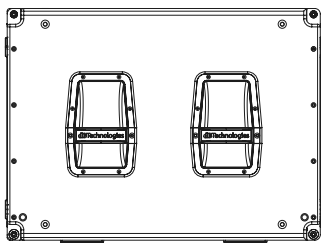
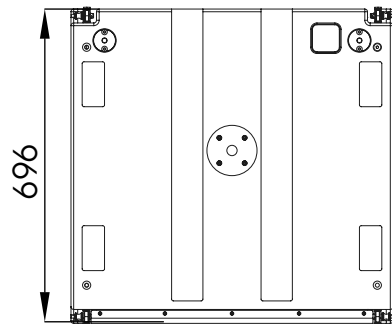
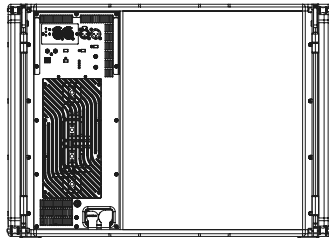

VIO S118

Datasheet

TRANSPORT & INSTALLATION ACCESSORIES

AF-VIO1



Adapter frame for flying VIO L208 under VIO S118 / VIO L210 and groundstacking VIO L208/ L210 above any VIO sub.

DO-VIOS118



Dolly for up to 3x VIO S118 / S118R

DSA-VIOL208



Groundstack adapter for VIO L208 on VIO S118 and S118R.

FSA-VIOL210



Adapter to fly VIO L210 under flown VIO S118.

FC-VIOS1



Functional cover for 2 VIO S118R / VIO S118.

GSA-VIOL210



Adapter to stack VIO L210 on VIO S118.

SWK-18 KIT



Kit consisting of 4 wheels for VIO S118R back panel.

CABLES

CAT6-CAT6-100 CAT6-CAT6 link cable (100cm) for DANTE™ AoIP and RDNet. EtherCON connectors.

CAT6-CAT6-170 CAT6-CAT6 link cable (170cm) for DANTE™ AoIP and RDNet. EtherCON connectors.

CAT6-CAT6-500 CAT6-CAT6 link cable (500cm) for DANTE™ AoIP and RDNet. EtherCON connectors.

DAC-70 XLR-XLR audio cable (70 cm).

DAC-500 XLR-XLR audio cable (500 cm).

DCK-27T Cable-Set containing 2x DAC-70 and 2x DPTC-70L.

DPTC-70L PowerCON TRUE1-PowerCON TRUE1 power link cable (70cm).

DPTC-160L PowerCON TRUE1-PowerCON TRUE1 power link cable (160cm).

DPTC-500L PowerCON TRUE1-PowerCON TRUE1 power link cable (500cm).

DPTC-1000M Mains PowerCON TRUE1 cable (10m). Different plugs available for several countries.

DPTC-2000M Mains PowerCON TRUE1 cable (20m). 16A CekON.

RDC-45F RJ45 to XLR 3 poles female conversion cable, 6 cm length. The cable converts from RDNet RJ45 to XLR.

RDC-45M RJ45 to XLR 3 poles male conversion cable, 6 cm length. The cable converts from RDNet RJ45 to XLR.

RJ45-RJ45-150 RJ45-RJ45 link cable (150cm) for RDNet speakers. EtherCON connectors.

RJ45-RJ45-75 RJ45-RJ45 link cable (75cm) for RDNet speakers. EtherCON connectors.